

THE LANDSCAPE ARCHITECT PROGRAMME 50 YEARS

APRIL 22
ALNARP

2022

OPEN HOUSE

x LARKDAGEN

The landscape architect programme at the Swedish University of Agricultural Sciences continues the celebration of its **50th anniversary** by hosting an **Open House**. We welcome everyone to take part in this event which will be filled with activities, knowledge exchanges, and creativity! The open house takes place on **April 22** in Alnarp and is co-hosted with **Larkdagen**.

More about the celebration and registration can be found here:



Programme

Aulan

- 09:00 **Welcome:** Open House*
- 10:00 **Lecture:** Lina Berglund-Snodgrass - SLU/BTH*
- 11:00 **Lecture:** Alfred Nerhagen - Helsingborg municipality*
- 11:30 **Lecture:** Henrik Sjöman - SLU*
- 12:15 **Panel discussion:** 'How will we dwell and live in 50 years?'
- 15:30 **Presentation:** The landscape architect 2042 - a future reconnaissance*

Between the activities in the Auditorium, the film 'Voices about the creation - The landscape architect programme 50 years' is shown. *

Loftet

- 09:45 **Välkomnande:** Larkdagen*
- 10:00-16:00 **Expo:** The Larkdagen's corporate fair*
- 13:30 **Workshop:** Green roofs - SGRI*

*Swedish **English

Ateljén

- 09:30 **Workshop:** Develop collaboration within SLU Landscape*
- 11:00 **Workshop:** Design teaching and research at SLU - Del 1**
- 13:00 **Workshop:** How to get a private life and a PhD**
- 14:30 **Workshop:** Do you want to design a charrette for architect students? Get engaged in the Swedish-Kenyan IFLA conference 2023: Emergent**

Studio

- 09:00 **Workshop:** Studio II Part 1- Live-critique *
- 10:00 **Workshop:** Studio II Part 2- Live-critique *
- 11:00 **Workshop:** Studio II Part 3- Live-critique*



Programme

Outdoors

- 10:45 **Tour:** Guided tree tour in the Alnarp park with Patrick Bellan*
- 13:00 **Workshop:** Design teaching and research at SLU - Del 2**
(NB! Takes place in Semlan)
- 14:45 **Tour:** Guided nature tour in the Landscape lab with Björn Wiström*
- 16:00 **Toast:** The open house ends with a festive toast to celebrate the 50th anniversary of the landscape architect programme*

Meet up at Bobos Hjärta for all outdoor activities.

*Swedish **English

Exhibitions

Foajén:

- Slides - Nostalgic pictures from the programme

The corridor:

- Dynamic expansion
- Student work from programme courses

Loftet:

- Company showcases in connection to Larkdagen

Food

- 14:00 **Cake part:** Come and take a piece of cake in the Larkkaféet!

The following food options will be available during the day:

- **The Plant Café** in the Foajén
- **Foodtrucks** outside of Alnarpsgården
- **Restaurant Alnarp 9**



Workshops

Develop collaboration within SLU Landscape

Description:

Collaboration with the outside world is common within SLU Landscape. Today, collaboration in research and teaching takes place with municipalities, authorities, media, organisations, companies and others. What does today's collaborative landscape look like, and what benefit do we have from it, at SLU and outside? How can our collaborative efforts be promoted, simplified, or further developed? What are the needs within and outside SLU and what benefit can we have from a senior lecturer in the subject of urban environments?

Language:

Swedish

How to get a private life and a PhD

Description:

This workshop invites for a round-table discussion about PhD life and how to make a balance between job and private life. How to maintain a private life while studying for a PhD degree? Is your PhD expanding indefinitely at the expense of everything else? What we should do when it feels to be overworked and out of balance. In group discussions, we will hear and learn from each other's experiences.

Language:

English

Do you want to design a charrette for architect students? Get engaged in the Swedish-Kenyan IFLA conference 2023: Emergent Interaction

Description:

IFLA 2023 is hosting a charrette for architecture students across the globe. A charrette is a fast-paced and fun collaborative workshop for exploring solutions to a specific challenge. What does that really mean, and how can one design it? What can it potentially become if you are the one formulating the conditions for it? Come and get involved in the IFLA conference, and explore the charrette of 2023! In this workshop, you will learn how to design a charrette. You will get a chance to be inspired from presentations of previous year's concepts, and start workshoping next year's IFLA 2023 charrette! This workshop is an opportunity to start getting involved in an international conference, getting to know new people and organising an exciting student charrette for students all over the world!

Language:

English



Workshops

Studio II - Housing in an urban context

Description:

During the second year of the landscape architect programme, students take their second studio course which introduces them to urban design and urban development. The course provides an understanding of how the living environment can be designed as part of a cohesive urban landscape based on local conditions.

During this workshop, the opportunity is given to gain insight into a specially adapted critique element in the course. The students present the structural plans they have developed for the new district of Västerbro in Lund.

Language:

Swedish

Design teaching and research at SLU

Description:

This is the first of two workshops within the CFI-project Site impressions in sustainable landscape design - network activities to strengthen design research at SLU, gathering teachers, researchers, students and practitioners with interest in urban landscapes and their design. In this network activity we explore how site impressions/aesthetic environmental experiences, connecting embodied poly-sensual experience to critical reflection, can become recognized to contribute to creating sustainable urban landscapes.

The overall objective is to strengthen collaboration and knowledge exchange in the subject field of landscape design at the LAPF and SOL departments, and make design work at SLU more visible. Furthermore, our ambition is to initiate conversations with other universities, for inspiration and knowledge exchange supporting design research at SLU, and shed light on the potential for a more long-term capacity building initiative, here suggested as a "SLU Landscape Design Research Forum".

The workshop consists of a round table discussion and an outdoor activity.

Round table discussion (1h)

Teachers, students, researchers and practitioners, exchange experiences with design teaching and research at Alnarp and Ultuna. We discuss design courses at Alnarp and Ultuna, and student projects and master thesis projects involving design research.

Outdoor activity (1h)

In the Landscape Lab we experiment with encountering sites through observation and performative drawing.

Language:

English

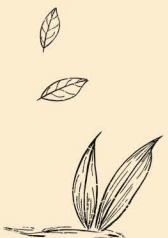

Lectures

Lecturer:

Lina Berglund-Snodgrass



Researcher and senior lecturer in physical planning at BTH, Blekinge Tekniska Högskola

Title:

Efficiency, freedom and community. What futures are we planning for, through car-free houses?

Description:

In my short lecture I will talk about planning for car-free houses and visions for the future. 'By asking the question: what are we planning for when we plan car-free houses?' I want to lift the discussion from a focus on the individual houses to a broader planning context and reflect on what ideas about the future the planning is based on.

Lecturer:

Alfred Nerhagen



Landskapsarkitekt at Helsingborg municipality, with a burning passion for the climate and co-creation

Title:

The landscape of challenges

Description:

In his lecture, Alfred will talk about various municipal projects where innovation and the challenges of the future are in focus.

Lecturer:

Henrik Sjöman



Teacher and researcher at SLU Alnarp & a Scientific curator

Title:

The importance of urban green environments to meet future challenges

Description:

The attitude around the city's green elements has in recent years become increasingly positive and where we today increasingly discuss its great value and importance in meeting future challenges. With this increasing focus on what the city's trees and other vegetation can help us to meet future challenges, the demands on us who design and plan these green elements will increase with demands for a significantly higher accuracy around the right plant and plant design for the right place and function, as in the future we will not agree to replace plants that have not established themselves or developed successfully. In Henrik's presentation, a future exploration of the challenges that landscape architecture faces in the development of long-term sustainable cities will be presented with thoughts on how and why we must take on these challenges.



Panel discussion

Based on what has been, we are now looking 50 years ahead. During the Open House, we welcome everyone to an exciting panel discussion where our reputable panellists discuss the issue:

'How will we dwell and live in 50 years??'.

Panellists:



Kristina Blenow

Professor of Landscape Planning directed towards Landscape Analysis, in particular Risk Analysis and Climate Change, at SLU



Angelica Åkerman

Private-practice architect as well as architect at the National Board of Housing, Building and Planning



Karin Grundström

Professor of Architecture at Malmö University



Ola Nylander

Professor of Architecture and Civil Engineering, Building Design at Chalmers University of Technology



Corporate fair

Exhibitors:

AFRY

Cado

CF Møller

Cotton & Graham

Edge

E-Planta Ekonomisk Förening

Essunga Plantskola

Hasselfors Garden

Milford Landskap

Norconsult

PE Teknik & Arkitektur

Planter

Rådhuset Arkitekter

SLU Alumn

SLU Karriär

Stångby Plantskola

Sveriges Arkitekter

Sweco Architects

Tidningen Utemiljö

Tidskriften Landskap

Trafikverket

Tyréns

VA Syd

Veg Tech

Växtväcket

WSP

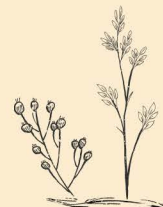

Alnarpsgården

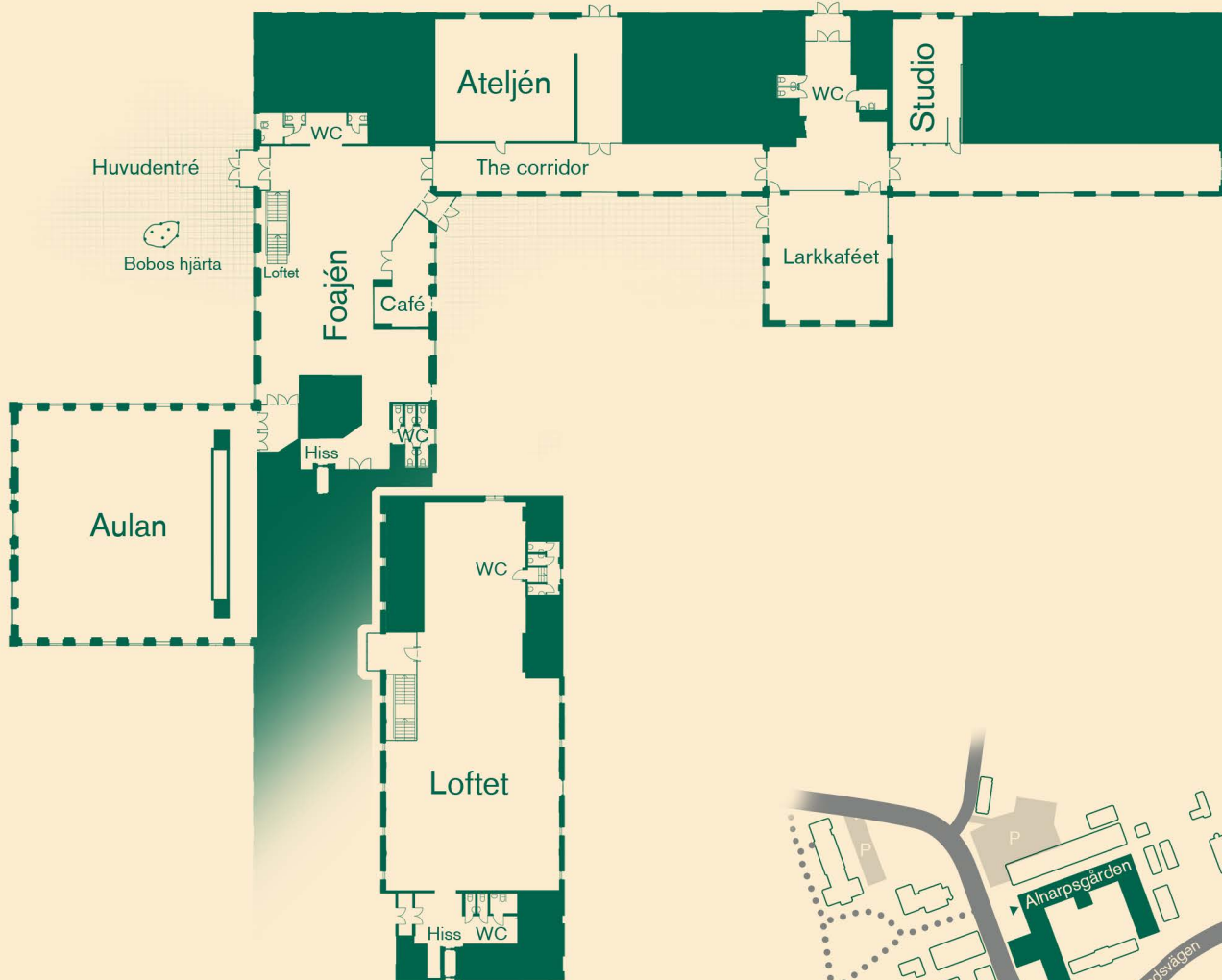

Address: Sundsvägen 6, Alnarp

